

## Zunanje okroglo brušenje

### Ravna brusilna plošča

#### Oblika 1

D x T x H

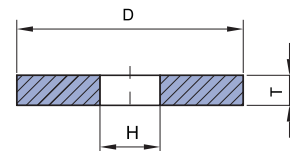

Primer naročila:

1 - 300x30x76,2

2A46/3J6V35

D	T	H
200	10 do 32	13, 16, 20, 25, 32, 40, 51
225	10 do 32	16, 20, 25, 32, 40, 50, 60
250	10 do 32	20, 25, 32, 40, 51, 76
300	10 do 50	32, 40, 51, 76, 127
350	16 do 50	32, 40, 51, 76, 127, 151
400	20 do 80	40, 51, 76, 127, 152.4, 203
450	20 do 80	76, 127, 152.4, 203
500	25 do 100	76, 127, 152.4, 203
600	32 do 100	152.4, 203, 305

### Brusilna plošča z izdolbino

#### Oblika 5

D x T x H - P x F

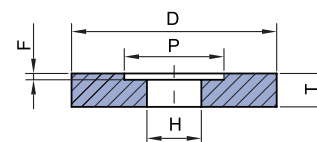

Primer naročila:

5 - 300x50x127 - 190x20

2A60/3K7V35

D	T	H	P	F
200	20 do 40	25, 32, 40, 51	110	
225	20 do 40	25, 32, 40, 51	110	
250	20 do 40	40, 51, 76	130	
300	32 do 80	76, 127	190	
350	40 do 80	76, 127	215	
400	40 do 80	127, 152.4	230	
450	40 do 100	127, 152.4	290	
500	40 do 160	127, 152.4	290	
600	32 do 160	127, 152.4	290	

F = max. T/2

### Brusilna plošča z obojstransko izdolbino

#### Oblika 7

D x T x H - P x F / G

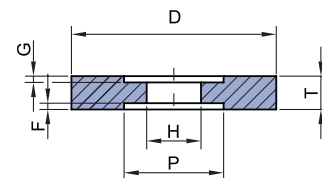

Primer naročila:

7 - 300x50x127 - 190x15/10

2A60/3H12/3V44

D	T	H	P	F,G
200	10 do 32	25, 32, 40, 51	110	
225	20 do 40	25, 32, 40, 51	110	
250	10 do 40	40, 51, 76	130	
300	13 do 80	76, 127	190	
350	16 do 80	76, 127	215	
400	20 do 80	127, 152.4	230	
450	20 do 100	127, 152.4, 203	290	
500	25 do 160	152.4, 203, 305	290	
600	32 do 160	152.4, 203, 305	290	

F+G = max. T/2